



'We brought this house back to life'

With reclaimed materials and an eye for design, Sally Hurman has infused her Fifties home in Surrey with country charm

FEATURE NAOMI JONES PHOTOGRAPHS ROBERT SANDERSON

STEP INSIDE

On entering via the pretty porch, you'll find flagstone floors, tongue-and-groove panelling and classic pine furniture. Greys and pinks tie the spaces together, with floral accents echoing the garden



HOUSE DETAILS

Homeowners Sally Hurman, a hairdresser and lifestyle blogger Getting Stuff Done In Heels, and her husband Gav, a company CEO **Family** Jake, 19, Sam, 18, Toby, 13, cats Beryl and Margot, and Molly the dog **Location** Surrey **Property** Four-bedroom, detached Fifties house

HOUSE VALUATION

Purchase price £654,000
Valued now at £1.1m

BUDGET BREAKDOWN

Building work £31,000
Kitchen & utility £18,000
Bathrooms £3,000 **Flooring** £4,500
Appliances £1,200 **Repairs** £6,800

TOTAL SPEND

£64,500

THE FLOORPLAN

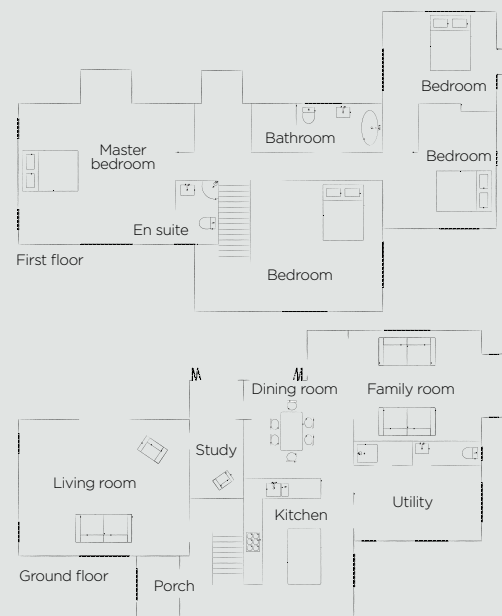

“
We’d driven past the
for sale sign many times
but never thought to look

BEAUTIFUL SYMMETRY

A pair of soft, purple
sofas flank the spacious
inglenook fireplace in
the cosy living room



PASTEL PERFECTION

The dining furniture, which Sally upcycled with chalk paint, was from Gav's mother

The first house Sally Hurman lived in with her husband Gav was an old tile-hung worker's cottage, and it was love at first sight. 'Gav and I bought it as fresh-faced newlyweds, not really planning too far into the future,' she says. 'We grew out of it when we had children, so in 2004 we bought a more spacious Seventies home.'

However, the couple dreamed of once again buying an older property packed with character and that had plenty of land in which their boys could play safely. As luck would have it, such a home was under their noses all the time, close to both of their mothers' houses. 'We'd driven past the for sale sign so many times,' Sally recalls, 'but as you couldn't see the house from the road, we'd never thought to look. Fortunately, one day, Gav did.'

Although it was a relatively new home, built around 1950, too small for the family and in need of a huge amount of modernisation, the couple

wasted no time snapping it up, seeing its potential. 'Not only is it on a two-and-a-half-acre plot,' Sally says, 'but Gav is also the most handy man in the world, so we knew we could transform the place.'

Rather than rushing straight into the work, the couple waited a couple of years to get to know the house and plan every detail carefully so that the project would run as smoothly as possible. 'Time was an issue,' she adds, 'and for budget reasons, we decided not to move out while the renovations took place. Instead, we bought a caravan and lived in the garden for eight months. As Gav was managing the build, it made sense for us to remain on site.'

The building work was extensive. The overhaul included a two-storey extension, a full rewire, new plumbing and boilers, and redecoration from top to bottom. 'The extension involved knocking out the back of the house, putting in bi-fold doors and creating an open-plan family room to the side of the kitchen-diner, resulting in one large, sociable ►



CLEVER DESIGN

Recessed shelves in the sides above the Aga are the perfect place to store cookbooks

IDEAS TO STEAL

Look to Sally's ingenious touches for home inspiration



↑ CONCEAL IN STYLE

Hide a bunch of faux flowers' plastic stalks inside a pretty jug



↑ REFRESH YOUR FRONT DOOR

A lick of paint, a pair of bay trees and climbing plants are all it takes



↑ POSITION PLATES LOGICALLY

With a rack above the sink, putting washing up away is easy

IDEAS TO STEAL

Beautify your bedroom with inventive, feminine flourishes



↑ REPURPOSE A COAT RACK

Keep necklaces and scarves to hand on decorative hooks



↑ EMBRACE INDIVIDUALITY

Make a statement with interesting bedside lamps, or create your own



↑ DISPLAY PRETTY POSTCARDS

Collect distinctive stationery and use it to style your surfaces

SHOP THIS ROOM

Alice metal bed frame, £399.99, Bensons For Beds. Josette wallpaper, £34 per 10m roll, Laura Ashley. For similar bedside table lamps, try CarlysVintage at Etsy. For similar velvet cushions, try Next Home



“

I've used shades from the same colour palette to create unity

↑ **CLASSIC APPEAL**
Sally used a warm grey in the en-suite shower room, where there's a curtain she made using a remnant of Heligan fabric by Laura Ashley

← **EASY ON THE EYE**
A pale painted metal bedstead blends seamlessly into the soft, romantic scheme of the master bedroom

living space,' Sally explains. 'Upstairs, we added a fourth bedroom and a bathroom and enlarged the landing so that we lost the long, dark corridor effect.'

The exterior and garden were also given the full Hurman treatment. 'We built a porch at the front to create an impressive and practical entrance using a salvaged door and beams reclaimed from a local barn,' she adds. 'Gav also designed and erected the beautiful oak arbour out the back.'

Next, Sally began designing the interiors, sharing images of her work in progress on Instagram (@gettingstuffdoneinheels) and amassing nearly 28,000 followers in the process. 'I love colour, especially soft greys, dusky pinks and purple,' she enthuses, 'so I've used several shades from that family throughout the house to keep it all unified.' It's a warm and confident palette, from the stone colours in the bedroom to the deep hues of the ▶



living room walls and sofas, and a gorgeous muted pink on the front door. Sally even changed the colour of the Aga they inherited with the house to match her scheme. 'It was originally racing green,' she recalls. 'It was nice enough, but when we were planning the kitchen, the hue just wasn't going to look right, so we had it re-enamelled in an aubergine colour. Some friends were surprised that we didn't play it safe with grey or black, or even white. But we knew the moment we saw it that the purple was what we wanted. We haven't once regretted it.'

The Shaker-style kitchen units – classic and stylish as well as robust enough to stand the test of time – are in Farrow & Ball's Hardwick white. Sally is a big fan of the brand: 'Sometimes I feel like I've swallowed the paint chart,' she laughs, 'but I simply adore all of their soft and chalky colours.'

Almost a decade on from the complete overhaul of their home, the dust may have settled but has the hassle of the renovation been forgotten? 'Not really,' Sally smiles. 'We were both fairly battle-scarred afterwards. We learned that everything takes twice

as long and costs twice as much as you think it will, but you have to keep smiling. I was trying to take care of our boys as best I could amid the surrounding chaos. Gav was working all hours running his company and managing the build. To be honest, it took a lot out of us: we were very tired and we didn't have much left in the way of savings.'

That said, Sally's love of the finished project is plain to see and her enthusiasm for her interiors has never waned. 'I'm delighted with how it's all turned out – but that doesn't mean I'm ever going to stop making little changes,' she admits. 'I'm always moving things around, tweaking and repainting. The boys don't even bat an eyelid any more if they come home to a different coloured door, or something else painted or shuffled round.'

Having journeyed together as a family though a beloved worker's cottage to a Seventies build to this gorgeous Fifties four-bed family house, Sally has finally recreated that cosy, country feel she fell in love with all those years ago. And no amount of tweaking will ever change that. **GH**

← **HAND CRAFTED**

Gav designed and built the arbour and trained the grapevine around it to provide shelter, come rain or shine

↓ **RURAL IDYLL**

The house is set in more than two acres of beautiful countryside – the perfect backdrop for informal parties



ONE SIMPLE CHANGE

Throwing a summer party? Use specialist transfers and pens (try Letraset Promarkers, £1 each, Cowling & Wilcox) to decorate secondhand glassware and turn sherry glasses into candles (try Hobbycraft for candle-making supplies). For miniature flower displays, remember to choose vases with narrow necks – they are far easier to arrange stems in.

